



INSTRUCTION BULLETIN

No. 340502
Machine: 800
Published: 9-03
Rev. 00

NOTE: DO NOT DISCARD the Parts List from the Instruction Bulletin. Place the Parts List in the appropriate place in your machine manual for future reference. Retaining the Parts List will make it easier to reorder individual parts and will save you the cost of ordering an entire kit.

NOTE: Numbers in parenthesis () are reference numbers for parts listed in Bill of Materials.

Installation instructions for kit number 380712

SYNOPSIS / PROBLEM:

This kit contains the parts needed to install a turn signal kit on the model 800 sweeper.
Please follow step-by-step instructions.

SPECIAL TOOLS / CONSIDERATIONS: None

(Estimated time to complete: 2 hours)

PREPARATION:

(Refer to FIG. 1, 2 and 3)

1. Start the machine, and check that the debris hopper is empty. Empty the debris hopper if necessary.
2. Park the machine on a level surface. Secure the debris hopper in the raised position with the hopper support bar.



WARNING: Raised hopper may fall. Engage hopper support bar.

3. Turn the machine engine off.

FOR SAFETY: Before leaving or servicing machine, stop on level surface and set parking brake. Then turn off machine and remove key.

4. Disconnect battery cables from machine.



WARNING: Always disconnect battery cables from machine before working on electrical components.

INSTALLATION:

(Refer to FIG. 1, 2 and 3)

1. Place light assemblies 46683A on a clean work surface.
2. Remove light covers from light fixtures 46683A. Using the light fixtures as a templates, and the measurements in FIG 1, mark and drill four mounting holes, and two wire holes in the left side front fender 65281.
3. Using the light fixture as a template, and the measurements in FIG 1, mark and drill four mounting holes, and two wire holes in the right side front fender 65281.
4. Install four grommets 10632-5 (13) in wire holes in each fender.

5. Attach bullet terminals 55272 to the wire ends on each of the light assemblies 46683A.
6. Route wires through grommets 10632-5. Secure light assemblies 46683A to fenders with M04 pan screws, lock washers 41140 and lock nuts 02850. Hand tighten hardware.
7. Secure turn signal assembly 60751 to the steering column with metal band and included hardware.
8. Install large rubber grommet 10632-8 in the control panel, next to the steering column. Route wires through the grommet.
9. Mount flasher bracket 24576-1 to the back side of the control panel with pan screw 06932, lock washer 41139 and flange nut 07789.

NOTE: Flasher bracket may already be installed on some machines.

10. Mount flasher 31922 in flasher bracket 24576-1. Secure in place with a cable tie.
11. Connect directional harness to flasher 31922. Secure the wire harness with cable ties 49266. **Connect 80 BLU to P. Connect 79 YEL to L. Connect 74G ORA to X.**
12. Connect the turn signals to the turn signal harness. Connect signal light harness to the main harness. Secure signal light harness with cable ties.

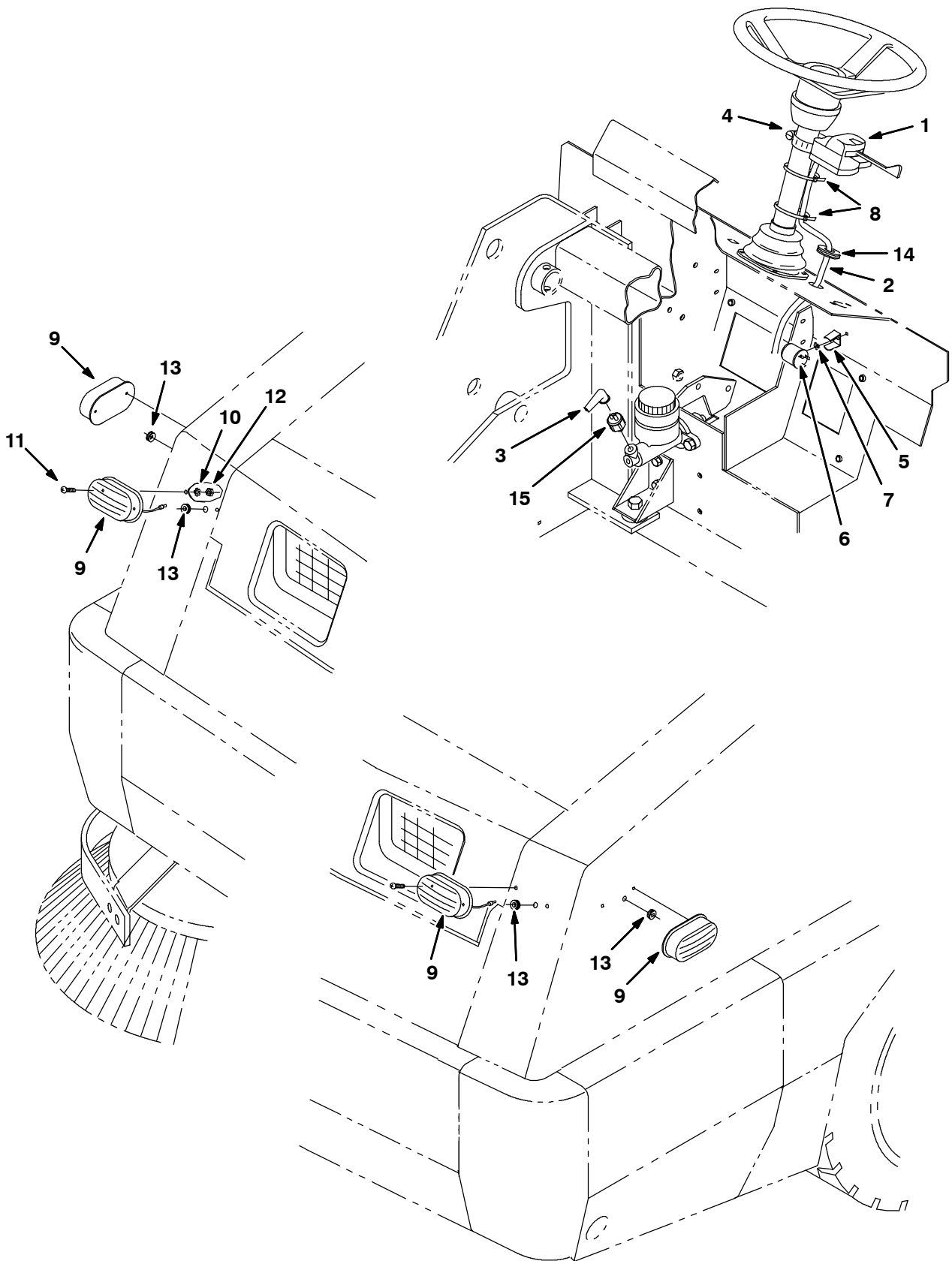
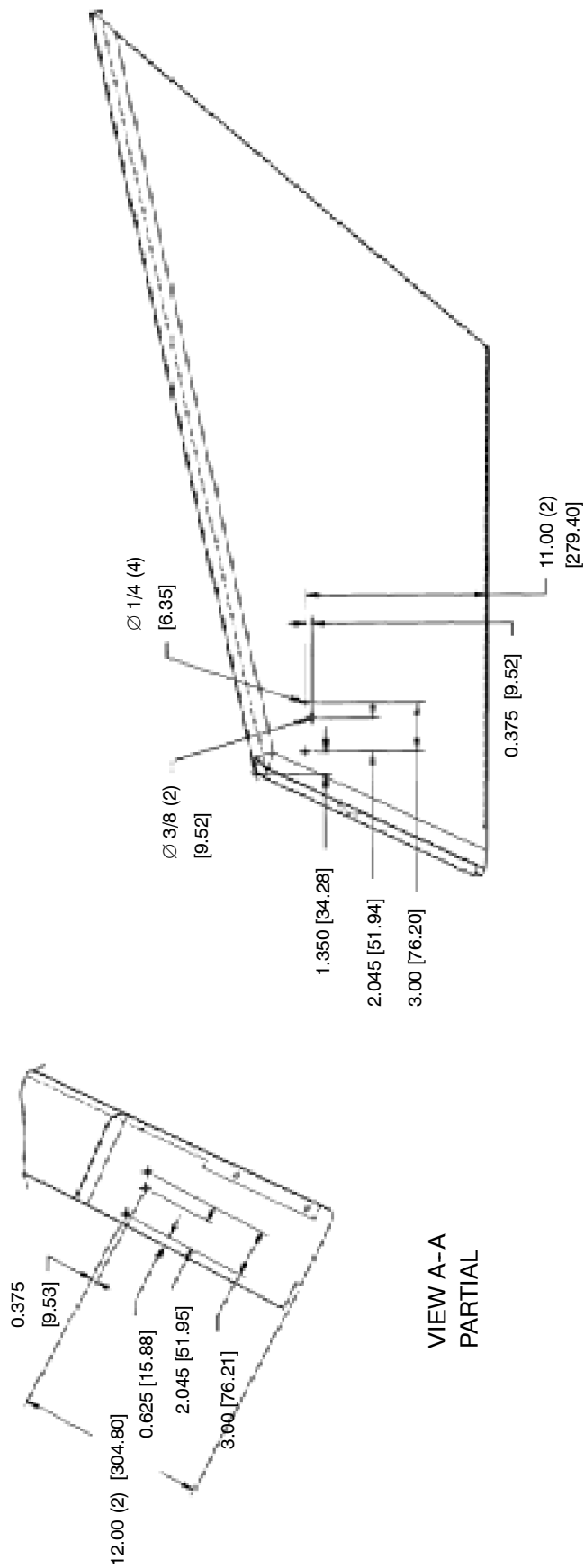

FIG. 1 - TURN SIGNAL KIT INSTALLATION



PANEL, FENDER, LH

VIEW A-A
PARTIAL

FIG. 2 - TURN SIGNAL KIT INSTALLATION

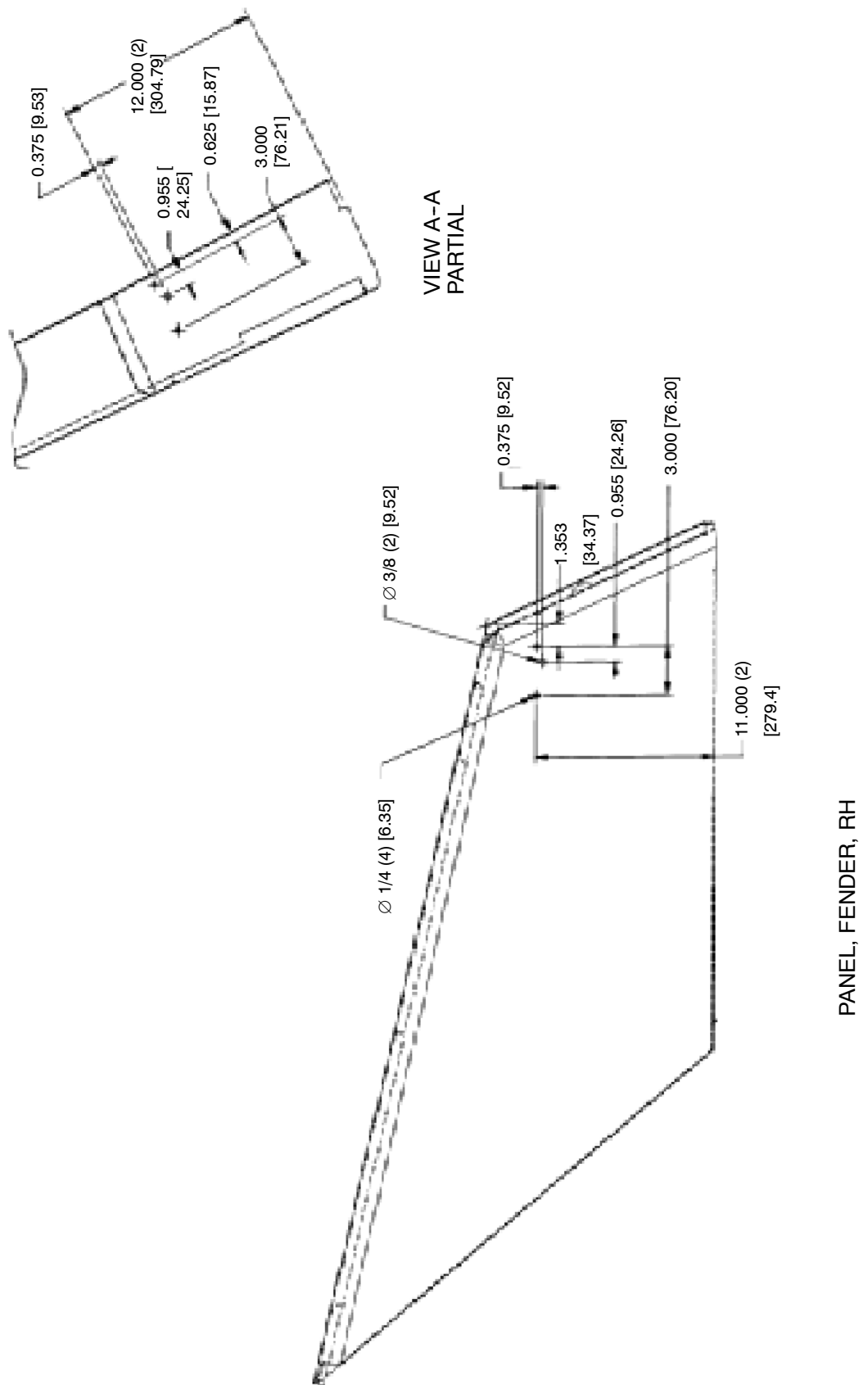

FIG. 3 - Right Hand Panel Rework

BILL OF MATERIALS FOR TURN SIGNAL KIT 380712

	Ref.	Tennant Part No.	Machine Serial Number	Description	Qty.
▽		380712	(004000-) Kit, Signal, Turn	1
▲	1	60751	(004000-) Signal Turn	1
▲	2	76423	(004000-) Harness, Directional	1
▲	3	18342	(004000-) Boot, Protector	1
▲	4	11531	(004000-) Clamp—Wormdrive, 0.81 – 1.50D	1
▲	5	24576-1	(004000-) Bracket, Flasher	1
▲	6	31922	(004000-) Flasher Heavy Duty	1
▲	7	41139	(004000-) Washer—Loc Int—Ext 10 Pltd	1
▲	8	49266	(004000-) Tie, Cable	4
▲▽	9	34848	(004000-) Light Assy Mark/Yel 12V— . A	4
▲▲		87948	(004000-) Bulb, #194	1
▲	10	41140	(004000-) Washer—Loc Int—Ext .25 Pltd	8
▲	11	06927	(004000-) Screw, Pan, M04	8
▲	12	02850	(004000-) Nut, Hex, Lock	8
▲	13	10632-5	(004000-) Grommet Rbr 0.25ld For .09Matl	5
▲	14	10632-8	(004000-) Grommet,Rbr,0.75ld,For .13Matl	1
▲	15	13959	(004000-) Switch	1

TENNANT COMPANY
P. O. Box 1452
Minneapolis, MN 55440-1452